

Square in a Square (- with a slash!) (January BoM, 2021) : Scrap fabric colourway for males.

- Please select pairs of similar colourways ie mainly blue... or mainly greens... as they work well when we get to the slashing technique
- Cut 2x 6 ½" and 2 x 10 ½ " lengths from the 2 ½ " wide strips provided.
- Check the accuracy of your ¼ " foot.
- Please press all seams *out from* the centre square.
 1. Sew both 2 ½" x 6 ½" strips to opposite ends of the 6 ½" square. Press seam. Fig.1
 2. Sew both 2 ½" x 10 ½" strips to the remaining opposite ends and press seam. Fig.2
 3. The finished block will be 10 ½" Fig.3

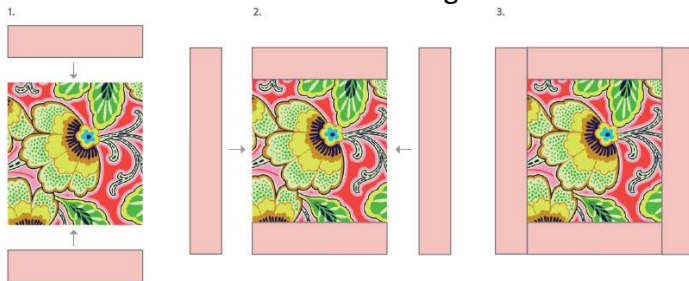

Now for the slash if you are interested in trying something different to liven up a very simple pattern!

OR simply bring back the blocks finished as above and we will pair up, slash and join blocks at a Busy Bee

1. Place 2 blocks right side up, on top of one another matching up so the long borders are on the same edge and feel for the seam lines to match as closely as possible
2. Cut a slice through both at the same time – through from one long edge to one short edge – be careful to not get too close to the corner seams.
3. Mix and match and sew back together, ensuring you line up the original long edges and the short edges
4. NB: ***It will end up wonky*** which gives it an interesting sense of movement
 - ***Please DO NOT trim your block***

1 & 2



3

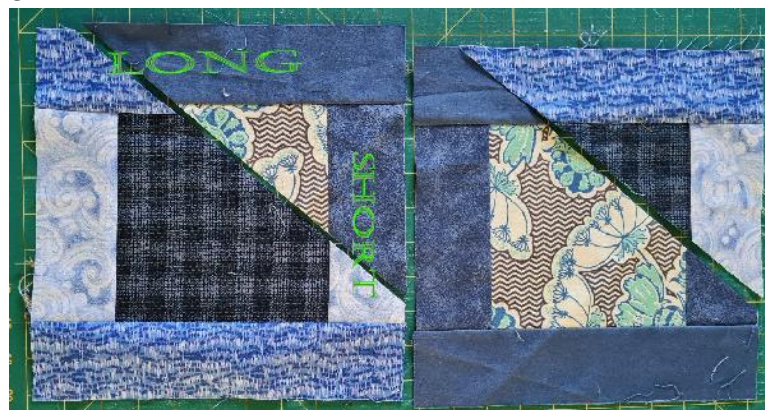

3 & 4

Pink – there is no overlap

which results in ...

Green – there is now a deliberate mismatch of the seams

The outside borders are wide enough to allow us to come up with a desired finished block size as we slash, join and make the final trim, prior to deciding on a layout for the quilt tops.

